

Lugus  
HOMES

39 Crimsworth Road, London, SW8 4RJ  
Asking price £575,000









# 39 Crimsworth Road

London, SW8 4RJ

- Two-bedroom Victorian ground floor flat
- Located on the quiet and desirable Crimsworth Road
- Just 0.2 miles from Nine Elms Station (Northern Line)
- Short walk to Battersea Park
- Private garden
- Victorian sash windows
- South-east facing
- Modern bathroom suite

A delightful two-bedroom Victorian ground floor flat with a private front door and garden, located on Crimsworth Road, a hidden gem just behind Nine Elms Station (Northern Line) and within walking distance of Battersea Park.

This charming flat offers well-proportioned living space with attractive period features and direct access to a private garden – perfect for relaxing or entertaining outdoors.

The location strikes a wonderful balance between peace and convenience. Crimsworth Road is quiet and residential, yet the property is just moments from excellent transport links, including Nine Elms Station and numerous bus routes. The vibrant amenities of Nine Elms, from independent bars and restaurants to pubs and supermarkets, are within easy reach, alongside the open green spaces of Battersea Park.





[Directions](#)







Floor Plans

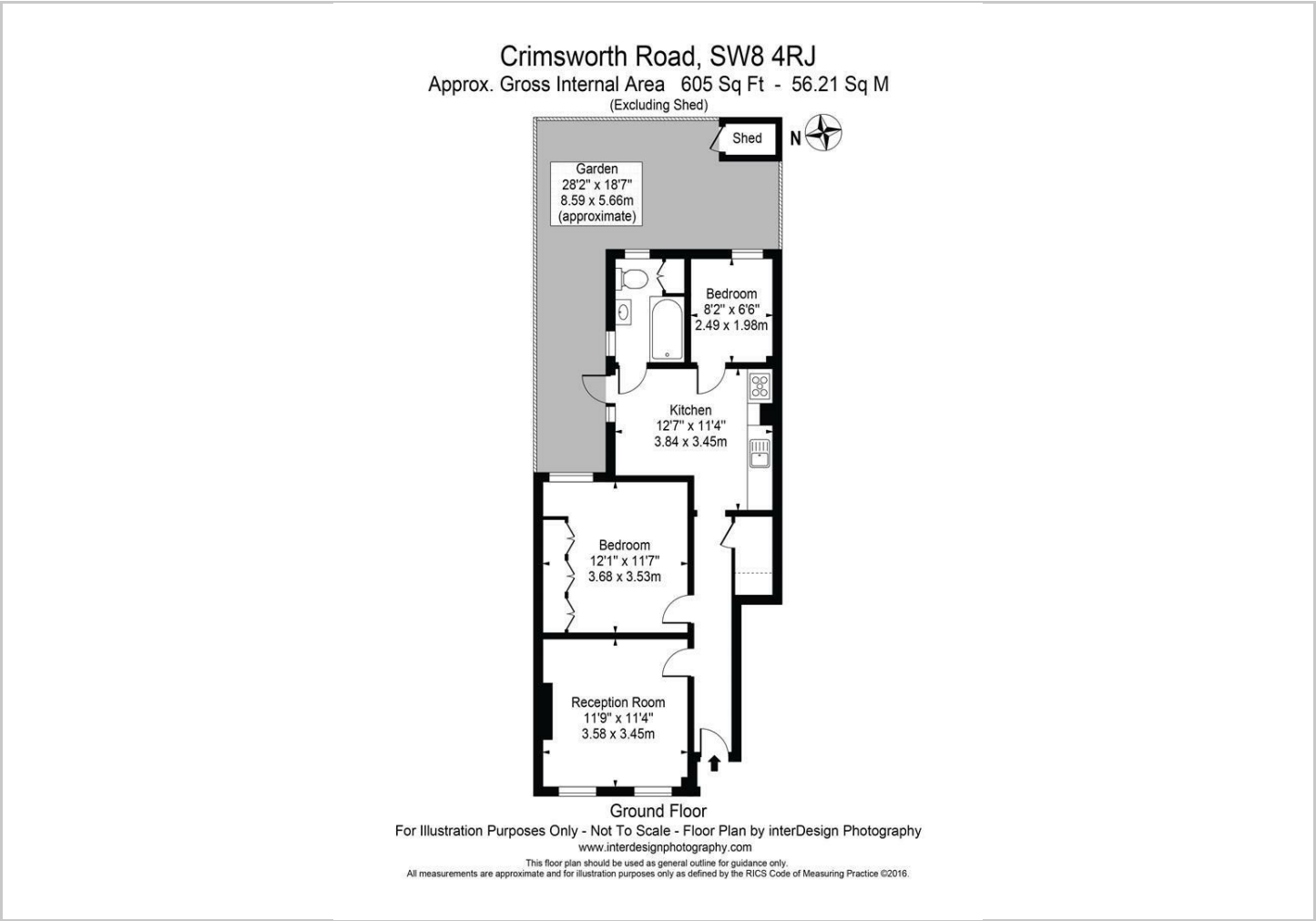

Viewing

Please contact our Lugus Homes Office on 07787 560885 if you wish to arrange a viewing appointment for this property or require further information.

The particulars are set out as a general outline only for the guidance of intended purchasers or lessees, and do not constitute, any part of a contract. Nothing in these particulars shall be deemed to be a statement that the property is in good structural condition or otherwise nor that any of the services, appliances, equipment or facilities are in good working order. Purchasers should satisfy themselves of this prior to purchasing.

24 Lower Downs Road, Raynes Park, London, SW20 8QG  
Tel: 07787 560885 Email: info@lugushomes.co.uk lugushomes.co.uk

Location Map

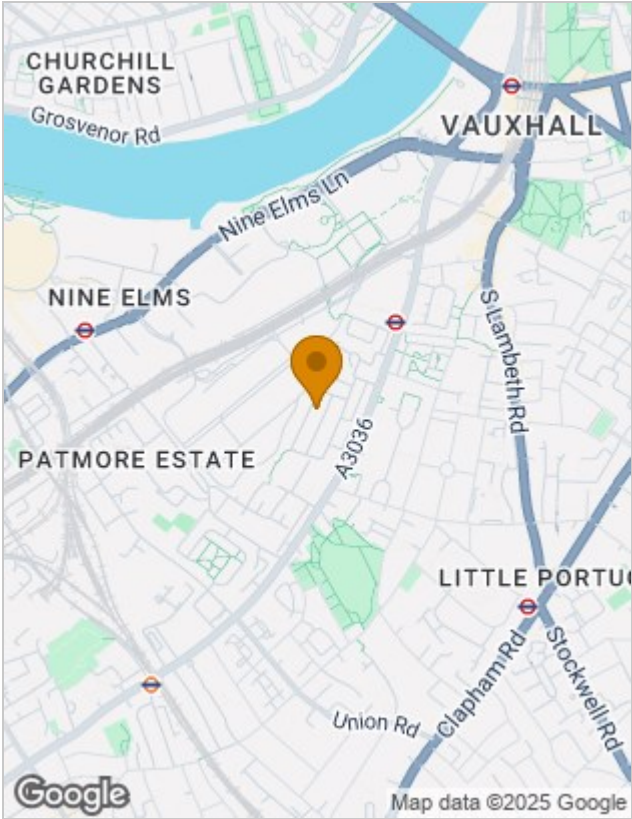

Energy Performance Graph

